

TEXAS PNEUMATIC TOOLS, INC.

Service, Operation AND Parts Manual

BENCH RAMMER **TX-8/2-1/2" & TX-8-4"**



Suggested Hose Whip Assembly: TX-2HW

TOOL
SPECIFICATIONS

PART #	WEIGHT	LENGTH	AIR CONSUMPTION	BORE	STROKE	BPM	TAPER	INLET	MINIMUM HOSE SIZE
TX-8/2-1/2"	7 lbs. 3.2 kg	16.25" 413 mm	15 CFM 425 L/min	1" 25 mm	2.5" 64 mm	1725	802	3/8" NPT	1/2" 13 mm
TX-8-4"	10 lbs. 4.5 kg	16.25" 413 mm	15 CFM 425 L/min	1" 25 mm	4" 102 mm	1240	802	3/8" NPT	1/2" 13 mm

~ Made in U.S.A. ~

www.airtools.com

Email: tptinfo@airtools.com

TEXAS

1-800-231-9740

NEVADA

1-800-858-1222

VIRGINIA

1-800-626-1091

MICHIGAN

1-877-575-5733

254-587-2533 (Int'l calls)

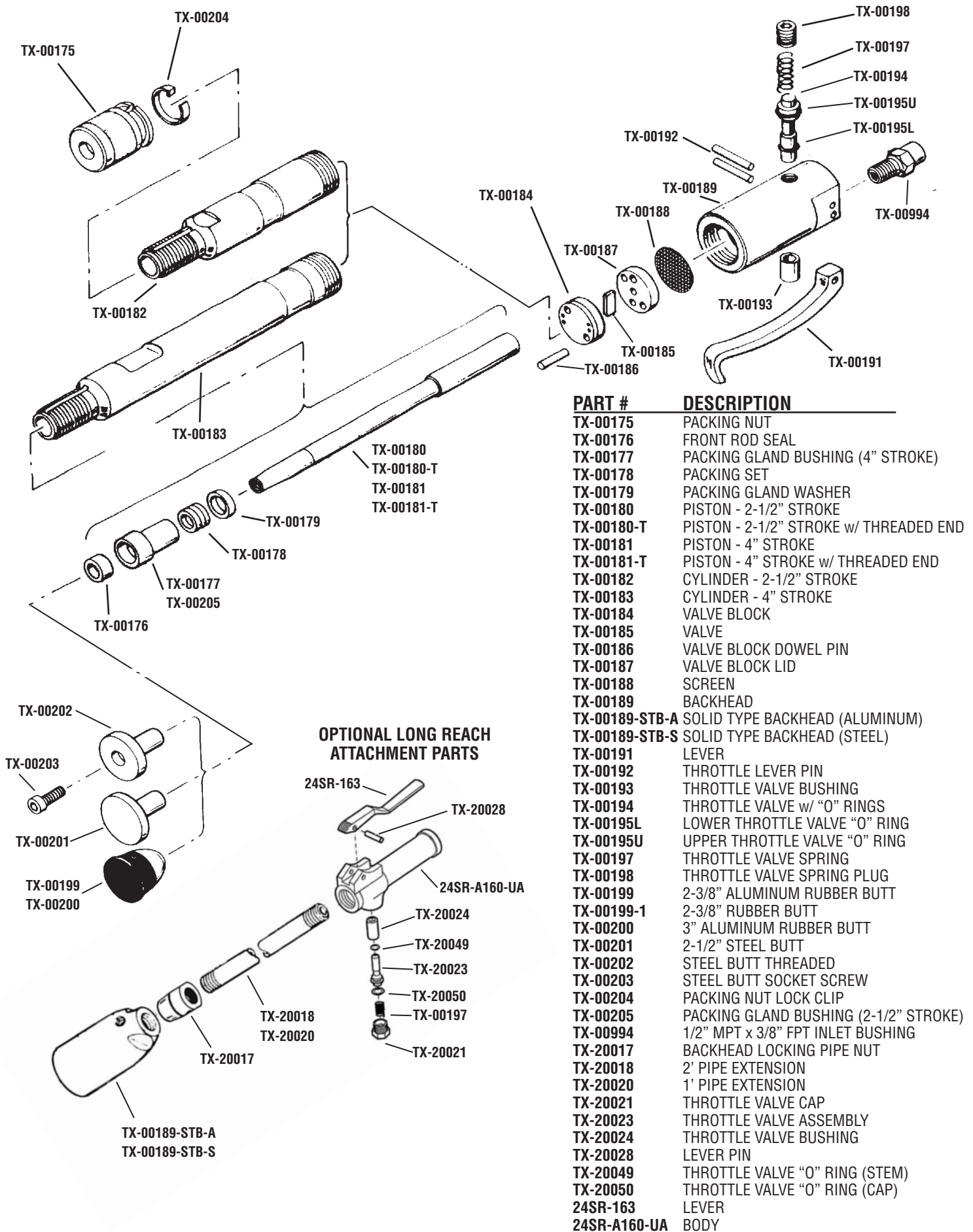

PART #	DESCRIPTION
TX-00175	PACKING NUT
TX-00176	FRONT ROD SEAL
TX-00177	PACKING GLAND BUSHING (4" STROKE)
TX-00178	PACKING SET
TX-00179	PACKING GLAND WASHER
TX-00180	PISTON - 2-1/2" STROKE
TX-00180-T	PISTON - 2-1/2" STROKE w/ THREADED END
TX-00181	PISTON - 4" STROKE
TX-00181-T	PISTON - 4" STROKE w/ THREADED END
TX-00182	CYLINDER - 2-1/2" STROKE
TX-00183	CYLINDER - 4" STROKE
TX-00184	VALVE BLOCK
TX-00185	VALVE
TX-00186	VALVE BLOCK DOWEL PIN
TX-00187	VALVE BLOCK LID
TX-00188	SCREEN
TX-00189	BACKHEAD
TX-00189-STB-A	SOLID TYPE BACKHEAD (ALUMINUM)
TX-00189-STB-S	SOLID TYPE BACKHEAD (STEEL)
TX-00191	LEVER
TX-00192	THROTTLE LEVER PIN
TX-00193	THROTTLE VALVE BUSHING
TX-00194	THROTTLE VALVE w/ "O" RINGS
TX-00195L	LOWER THROTTLE VALVE "O" RING
TX-00195U	UPPER THROTTLE VALVE "O" RING
TX-00197	THROTTLE VALVE SPRING
TX-00198	THROTTLE VALVE SPRING PLUG
TX-00199	2-3/8" ALUMINUM RUBBER BUTT
TX-00199-1	2-3/8" RUBBER BUTT
TX-00200	3" ALUMINUM RUBBER BUTT
TX-00201	2-1/2" STEEL BUTT
TX-00202	STEEL BUTT THREADED
TX-00203	STEEL BUTT SOCKET SCREW
TX-00204	PACKING NUT LOCK CLIP
TX-00205	PACKING GLAND BUSHING (2-1/2" STROKE)
TX-00994	1/2" MPT x 3/8" FPT INLET BUSHING
TX-20017	BACKHEAD LOCKING PIPE NUT
TX-20018	2' PIPE EXTENSION
TX-20020	1' PIPE EXTENSION
TX-20021	THROTTLE VALVE CAP
TX-20023	THROTTLE VALVE ASSEMBLY
TX-20024	THROTTLE VALVE BUSHING
TX-20028	LEVER PIN
TX-20049	THROTTLE VALVE "O" RING (STEM)
TX-20050	THROTTLE VALVE "O" RING (CAP)
24SR-163	LEVER
24SR-A160-UA	BODY

Service and Operations

Instructions for TX-8 Bench Rammers

AIR SUPPLY

For efficient performance, a regulated supply of clean, dry air is required (90 psi at the tool). Most air tools will give superior service if the air is moisture free and lubricated, plus down time will be minimized. If the compressor is pumping excessive water, a cooler or moisture separator (TX-MSS-400 or TX-MSS-800) should be attached to the compressor or air line. A filter, pressure regulator and Texas Pneumatic in-line lubricator (TX-0L) should be part of the air line system to the tool. The air supply line should be a minimum 1/2" I.D, hose with no restrictive couplings or fittings in the hose line. If quick disconnect air couplings are used, they should definitely be separated from the tool by the use of a hose whip (TX-2HW).

LUBRICATION

An in-line lubricator such as the Texas Pneumatic TX-0L is recommended. If an automatic lubricator is not used, it is recommended before using and after 2-3 hours use, to pour several drops of oil into the air inlet port. Texas Pneumatic Lubricating Oil (TX-PL001) or 5 wt. oil of good grade is recommended. A heavy oil will cause loss of power and efficiency. In the matter of preventative maintenance, Texas Pneumatic Tool Flush (TX-TF001) or similar solvent can be used to flush the tool. Add a couple of teaspoons to the air inlet port and operate the tool for a few seconds. It may be necessary to do this several times. The above should be done anytime the tool becomes sluggish or erratic or stops working. Flushing of the tool will most likely remove any foreign particles. After flushing and always before storage (this is most important if the air line has excessive moisture), the tool should be re-lubricated to prevent rust which will cause the tool to malfunction.

PREPARING FOR OPERATION

Disconnect the air line prior to any maintenance or repairs to the tool.

The TX-8 Bench Rammers are quality tools manufactured to close tolerances and care should be given to their maintenance, disassembly, and reassembly. The tightness of the packing has been set at the factory, and each rammer is ready for use. The tightness of the Packing (TX-00178) should be checked from time to time thereafter. You can check this by pushing the Piston (TX-00180 or TX-00181) in and out by hand. A slight drag should be felt when the Piston is moved in and out. If the drag is too great, the Packing Nut (TX-00175) should be backed off. If there is not enough drag to maintain compression and power, then the Packing Nut should be advanced. You have to remove the Packing Nut Lock Clip (TX-00204) from the slot in the Packing Nut to make the adjustment. For disassembly of the tool, you can remove the Butt from the end of the Piston by placing an open end wrench on top of the small end of the Butt and around the Piston. Strike the wrench with a couple of hammer blows, and the Butt should fall off. Most Butts are held only by the taper of the Piston. Some Butts use a Butt Screw (TX-00203) to retain the Butt on the Piston. Remove the Butt Screw and use the above procedure to remove the Butt from the Piston. Lift the Packing Nut Lock Clip (TX-00204) so the Packing Nut (TX-00175) can be unscrewed. Next, pull the Piston out of the Cylinder (TX-00182 or TX-00183) bringing with it the Packing Gland Bushing (TX-00177 or TX-00205), Packing (TX-00178), and Packing Gland Washer (TX-00179). The Front Rod Seal (TX-00176) can be pulled from the Packing Gland Bushing once it has been taken off the Piston. To clean or replace any valve parts, remove Backhead (TX-00189). The flats of the barrel can be placed in a vice so the Backhead can be unscrewed. The Screen (TX-00188) should be thoroughly cleaned. If the Valve (TX-00185) is worn badly, it should be replaced. The Throttle Valve Spring Plug (TX-00198) should be removed to inspect, clean or replace the Throttle Valve (TX-00194), Throttle Valve Spring (TX-00197) or Throttle Valve "O" Rings (TX-00195U or TX-00195L). The Throttle Valve Spring and "O" Rings should be carefully inspected and replaced periodically. Assembly of the tool is in reverse order. Light lubrication should be applied to all parts on reassembly. ***LAST, BUT MOST IMPORTANT, APPROVED SAFETY GLASSES SHOULD BE WORN AT ALL TIMES WHEN OPERATING THIS OR ANY OTHER PERCUSSION TOOL.***

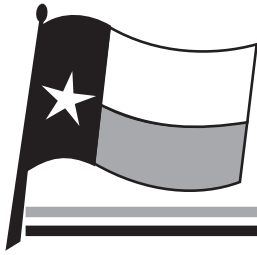

TEXAS PNEUMATIC TOOLS, INC.



TX-2HW



Butts
(Many other sizes and shapes available.)