

A.S.M.E. Certified Air Manifolds

TX-2AMF

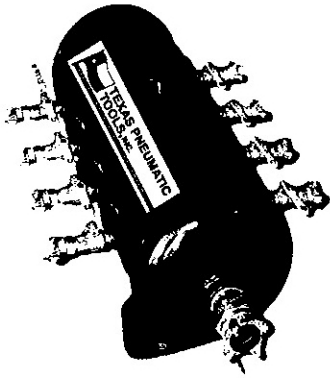

SPECIFICATIONS

MODEL #	TX-2AMF
WEIGHT	63 lbs
HEIGHT (Tank Only)	16"
HEIGHT (Highest Point)	18"
LENGTH	39"
TANK DIAMETER	12"
TANK CIRCUMFERENCE	37.75"
WIDTH W/ FITTINGS	22"
INLET SIZE	2"
NO. OF OUTLETS	8-3/4"
WORKING PRESSURE	200 p.s.i.
TEST PRESSURE	300 p.s.i.
CAPACITY	15 gal.
BOXED SIZE	40"x24"x18"
BOXED WEIGHT	76 lbs

Texas Pneumatic proudly introduces the TX-3AMF, the second in its series of ASME approved manifolds. This smaller version is much more accommodating to carry into confined spaces such as airliners for cabin and seat repair. It fits neatly into large toolboxes for storage. It can be equipped with universal (crowsfoot-type) couplers or 1/4", 3/8" or 1/2" quick disconnect industrial couplers with hose barb plug included.

Both sizes can be used in tandem to provide as many outlets as needed.

Keep work site uncluttered by having only one hose going to the work area.

Both meet all OSHA guidelines: ASME approved tank.

ASME pop-off valve (200 psi) to prevent excessive pressure buildup.

Equipped with a gauge to monitor working pressure.

Brass drain cock to vent water droplets.

TX-3AMF

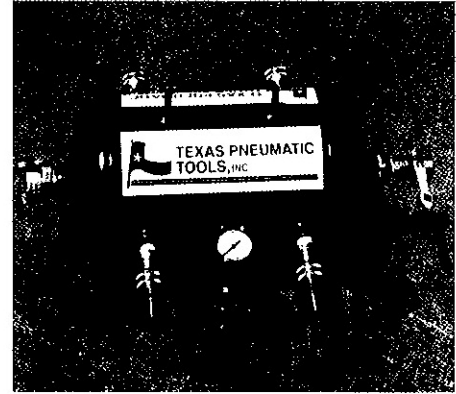

SPECIFICATIONS

MODEL #	TX-3AMF
WEIGHT	21-23 lbs
HEIGHT (Tank Only)	10"
HEIGHT (Highest Point)	12"
LENGTH	20"
TANK DIAMETER	8"
TANK CIRCUMFERENCE	25.75"
WIDTH W/ FITTINGS	14"
INLET SIZE	1"
NO. OF OUTLETS	4
WORKING PRESSURE	200 p.s.i.
TEST PRESSURE	300 p.s.i.
CAPACITY	2.5 gal.
BOXED SIZE	23"x19"x14"
BOXED WEIGHT	29 lbs

TX-3AMF-QC(1/2") 1/2" Industrial Quick Connect
TX-3AMF-QC(1/4") 1/4" Industrial Quick Connect
TX-3AMF-QC(3/8") 3/8" Industrial Quick Connect

☐ User friendly overall weight

☐ User ready on delivery

☐ Easily bolts to skids or other surfaces

☐ Multiple manifolds can be used in tandem

☐ Helps maintain a cleaner worksite

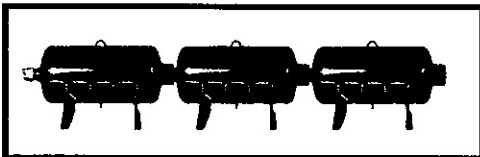

**For ASME Certified
Moisture Separators
Please See Page 28**

A.S.M.E. Certified Air Manifolds

Tank Style Manifold TX2AMF

1

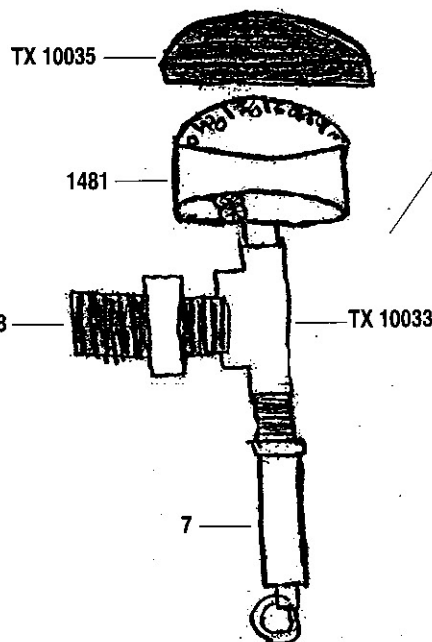
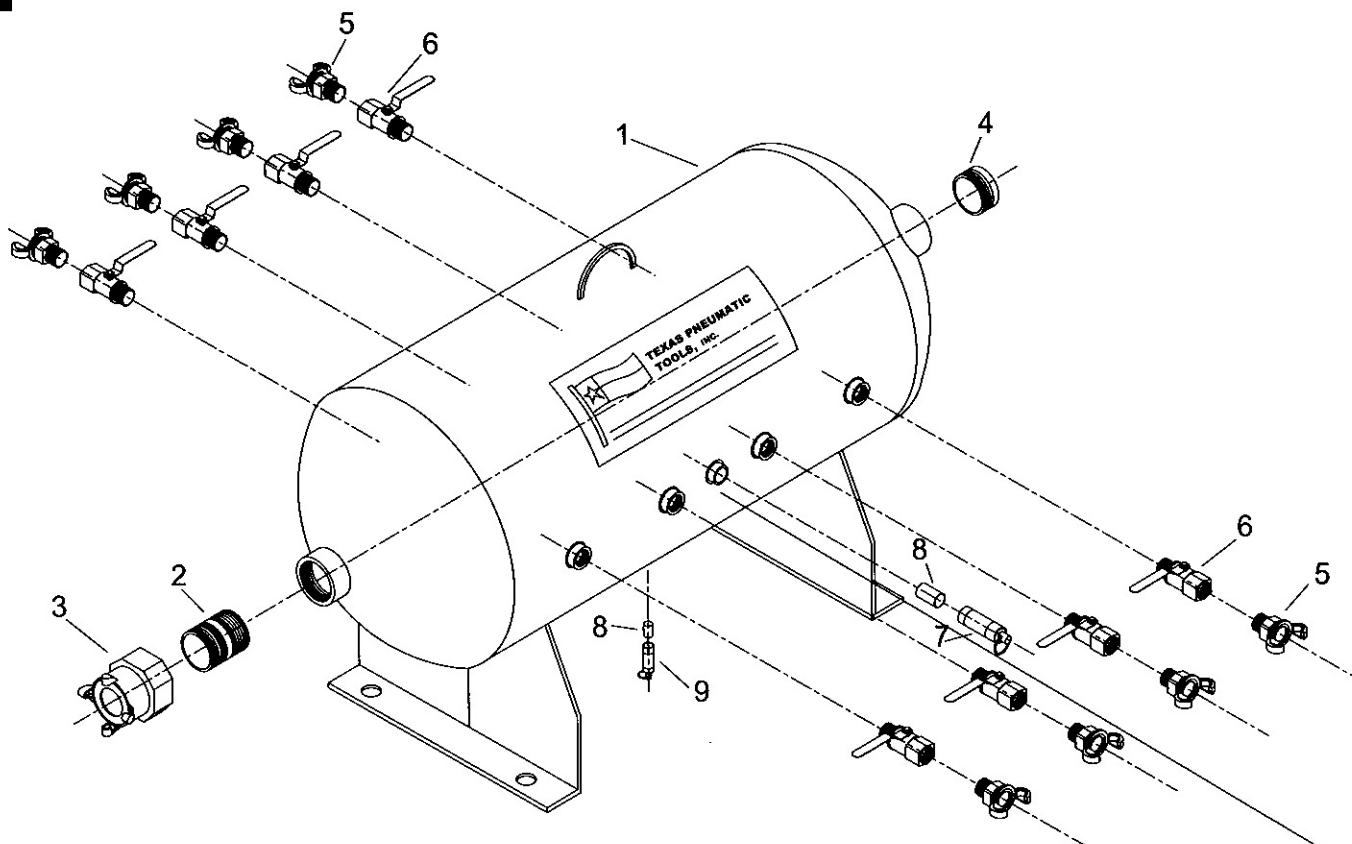

Part List

Index No.	Part No.	Description
1	TX-10029	MANIFOLD BODY
2	TX-10030	2" CLOSE NIPPLE
3	CFAM28	2" FPT X 4 LUG CROWSFOOT
4	TX-10032	2" SQUARE PLUG
5	CFAM7	3/4" MPT X CROWSFOOT
6	TX-10028	3/4" BALL VALVE M/F
7	TX-10004	1/4" SAFETY POP-OFF VALVE
8	TX-10031	1/2" MPT X 1/4" FPT BRASS HX BUSHING
9	TX-10005	1/4" DRAIN COCK
		* NOT SHOWN *
	1481	AIR GAUGE
	TX-10035	GAUGE COVER
	AMIS12	1/2" X 1/4" BUSHING